

# CONSTRUCTION D'UN ENSEMBLE IMMOBILIER MIXTE TERTIAIRE, HOTEL ET COMMERCE - RUE DE BELLE VUE DUNKERQUE



MAITRE D'OUVRAGE



10, avenue de Flandre  
59290 Wasquehal

MAITRE D'OUVRAGE



SOCIÉTÉ DE  
DÉVELOPPEMENT  
DU DUNKERQUOIS  
124, rue du Magasin Général  
59140 Dunkerque



ARCHITECTE



51, boulevard de Belfort  
59042 Lille cedex



















## PLAN DE PRINCIPE D'INSTALLATION DE CHANTIER

Indice	Date	Observations	Dessiné par :	Vérifié par :
A	13/12/2024	Emission initiale	C. SOURDIN	A. BETREMIEUX
B	20/11/2025	Mise à jour du fond de plan géomètre et ajout des axes des bâtiments	C. SOURDIN	A. DETOUT
C	10/12/2025	Mise à jour de la grue	C. SOURDIN	A. DETOUT
D	14/01/2026	Mise à jour clôture de chantier au niveau du passage piétons existant	C. SOURDIN	A. DETOUT
E	10/02/2026	Mise à jour de la sortie chantier	C. SOURDIN	A. DETOUT
F				
G				
H				
I				
J				

MANDATAIRE	<b>Rabot Dutilleul Construction</b> 10 Avenue de Flandre - CS 80100 59443 Wasquehal Cedex - Lille - France Tél : 03.20.81.53.53 www.rabotdutilleulconstruction.com			REF. AFFAIRE
				160 571
SERVICE / SOUS-TRAITANT	<b>SERVICE METHODES</b> 10 Avenue de Flandre - CS 80100 59443 Wasquehal Cedex - Lille - France Tél : 03.20.81.53.53	Cédric SOURDIN csourdin@rabotdutilleul.com 07.84.53.37.42		ECHELLE
				1/200
Service Méthodes				

	<b>MET</b>	<b>GO</b>	<b>PIC01</b>	<b>E</b>	<b>TN</b>	<b>TZ</b>	<b>PIC</b>	<b>EXE</b>
PROJET	EMETTEUR	LOT	N° DOC	INDICE	NIVEAU	ZONE	TYPE	PHASE

**LEGENDE**

-  Bâtiment existant
-  Bâtiment Futur
-  Emprise chantier
-  Circulation balisée du chantier
-  Circulation balisée des piétons
-  Cheminement piétons
-  Base vie et cantonnements
-  Circulation engins
-  Survol interdit en charge
-  Passage protégé
-  Aire de stockage / préf.
-  Aire de déchargement
-  Boîte à casques
-  Point Electrique
-  Point de Rassemblement
-  Point d'eau
-  Clôture de chantier
-  Sens de circulation

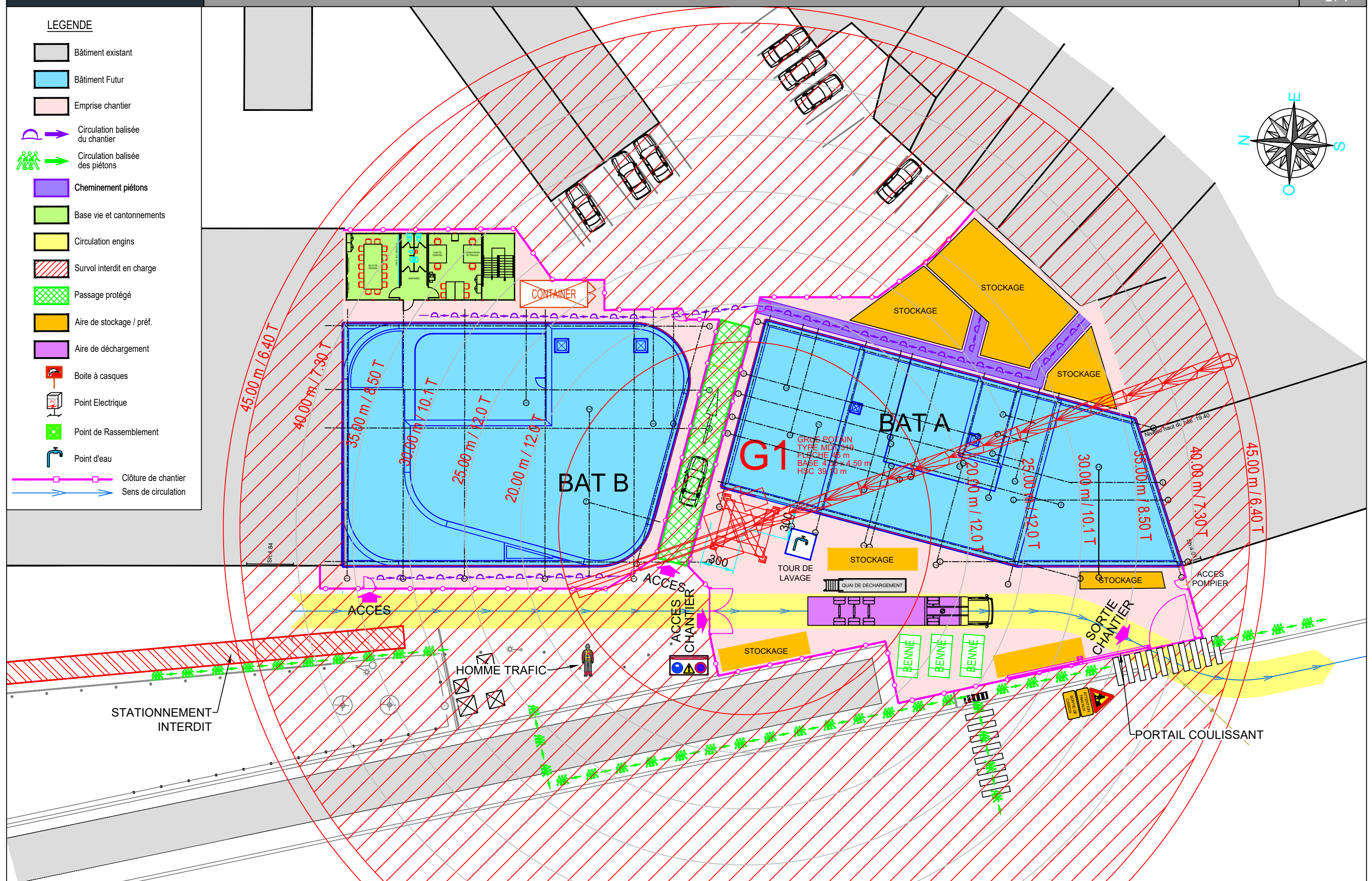
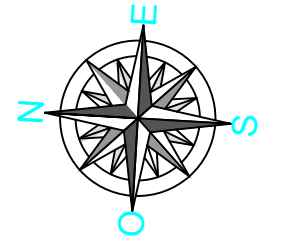

## CARACTERISTIQUES DE LA GRUE G1

TYPE	HSC	FLECHE	C / FL	CHARIOT	BASE	Niv. dessus semelles
MDT 319	39.10 m	45.00 m	16.60 m	12.00 T	4.50 m	4.22 NGF

Portée (m)	22,00	25,00	27,00	30,00	32,00	35,00	37,00	40,00	42,00	45,00
Charge (T)	12,0 T	12,0 T	11,3 T	10,1 T	9,4 T	8,5 T	8,0 T	7,3 T	6,9 T	6,4 T

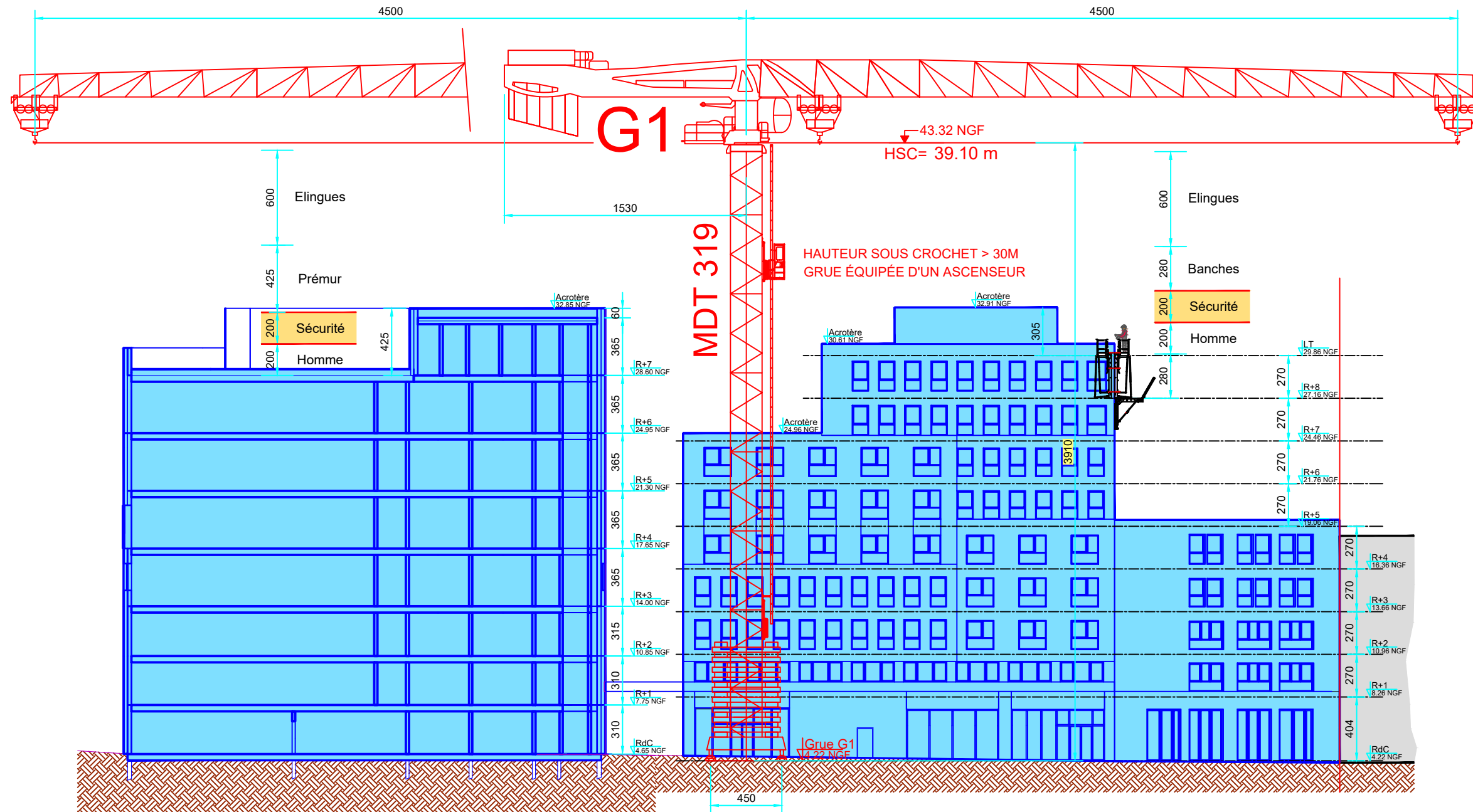

**NIVEAU RDC**  
BASE VIE ADMINISTRATIVE

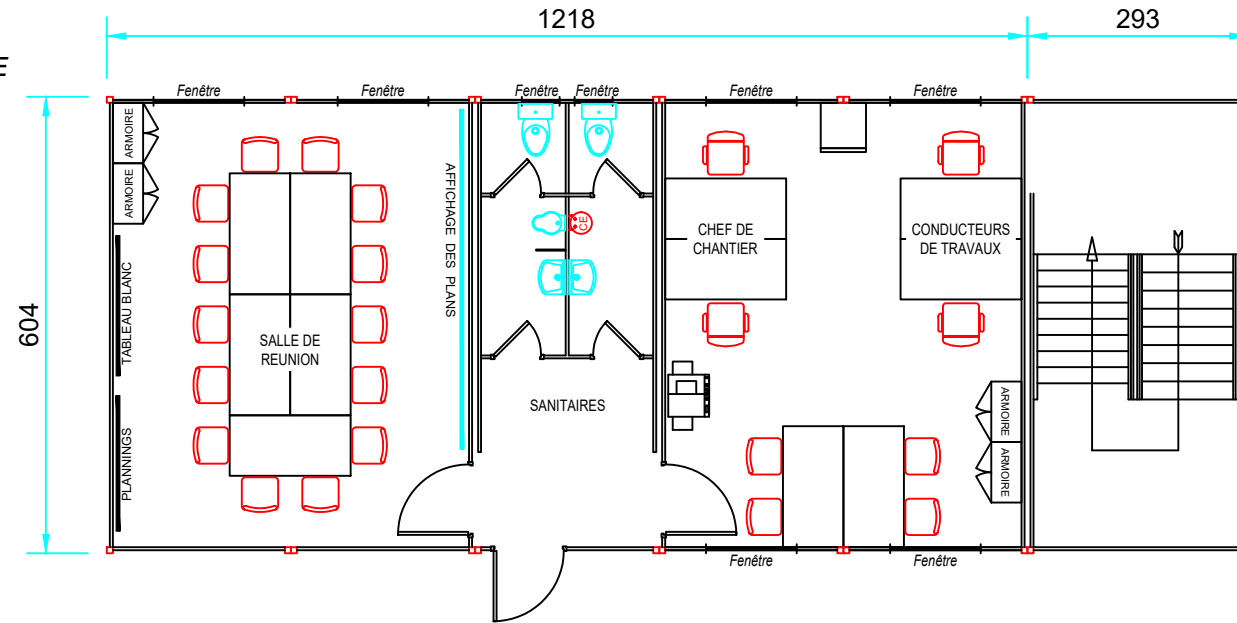

**NIVEAU R+1**  
BASE VIE COMPAGNONS  
PHASE GO

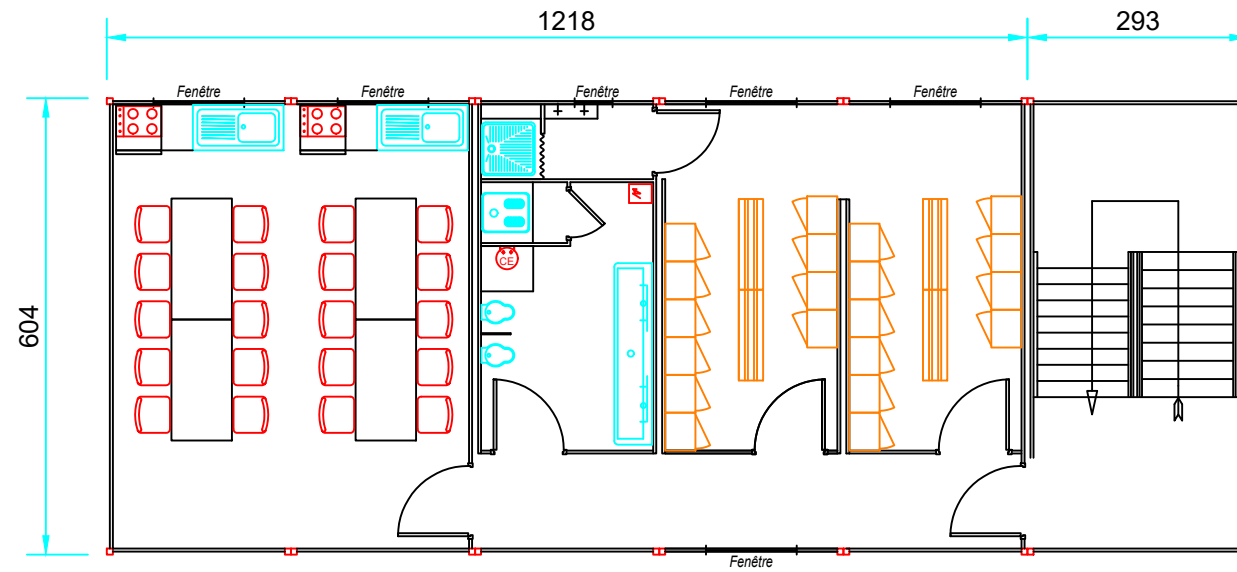

**NIVEAU R+2**  
BASE VIE COMPAGNONS  
PHASE CES

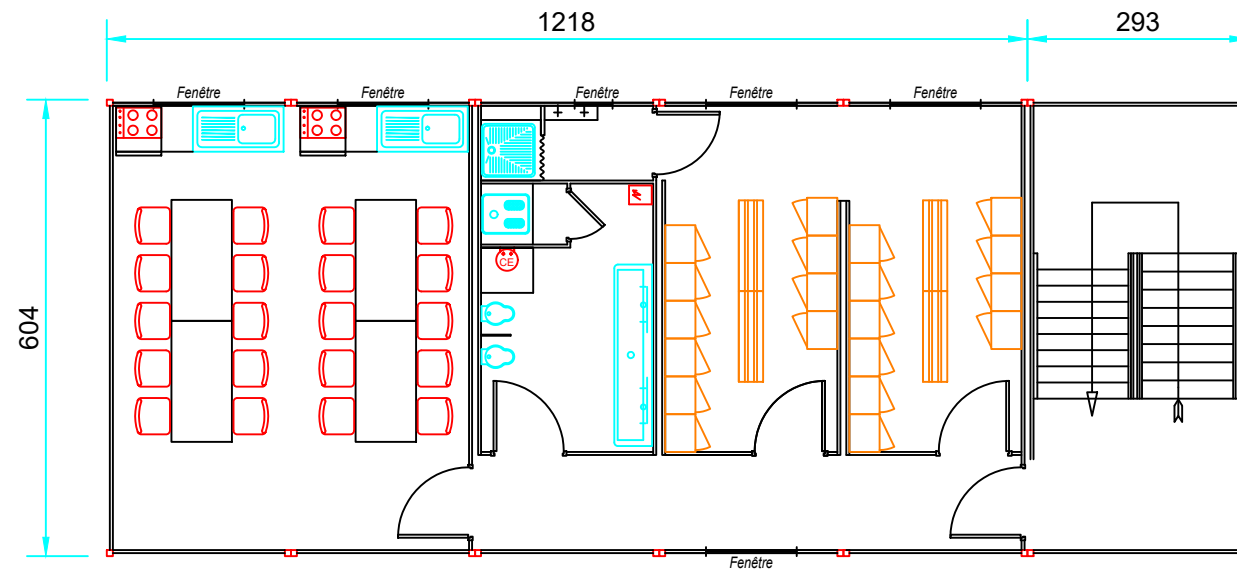

FAÇADE côté chantier

